

Drop & Take, No Mistake !

MAKE DOCUMENT FLOW EASY

Print, Copy, E-mail, and Scan with the Avision AM7600i Plus Series MFP

AM7630i Plus | AM7635i Plus | AM7640i Plus | AM7645i Plus | AM7650i Plus



Output
B&W

Paper size
A3

Up to
50 ppm

Work Smarter, Not Harder!

Intelligence copy function with Avision technology

Unique auto crop / deskew and blank page removal feature

The Avision's innovative intelligent copy allows you to insert your document easily to the feeder or on the glass platen, and then the next second a perfect copy can be done automatically. If a document is not inserted correctly, the image can be automatically cropped and straightened during scanning. Plus, with the blank page detection and removal feature, the blank page can be detected and deleted without being printed. All these features let you complete your copy efficiently and effectively.

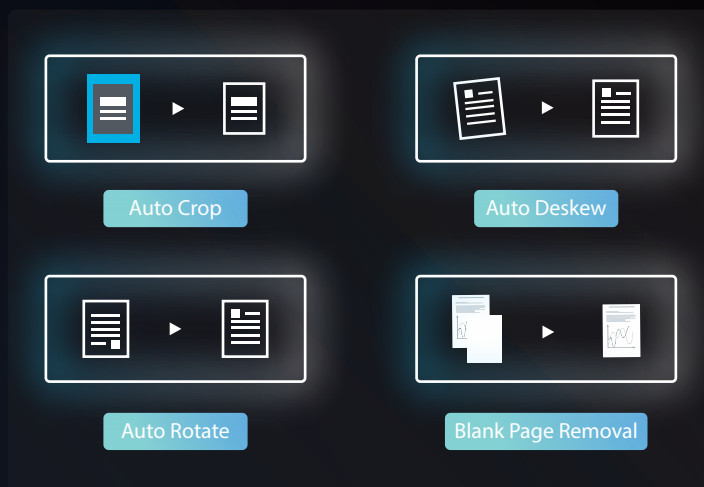

No more trouble to place document on feeder / platen glass

The intelligent "Drop N Take" feature allows you to simply load your document easily to the feeder or on the glass and then the next second your copy is automatically straightened. It is simply that easy!

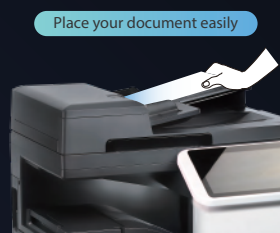
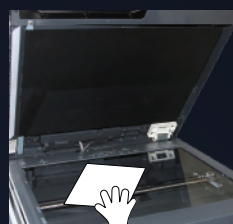

Two reading heads save twice working time

Featuring two reading heads, the product is able to achieve two-side (front and read side) scanning in one scan, meaning the page does not need to pass through the feeder twice to save your working time.

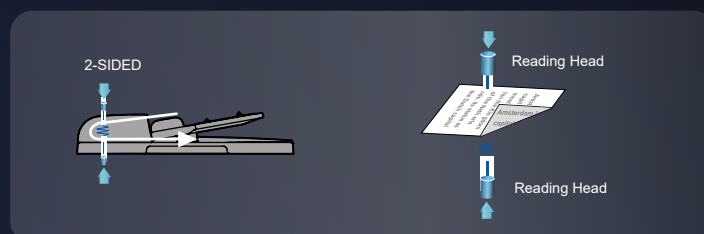

Easy-to-use via the simple user interface

Easy to read and navigate, the large 10-inch, bright color touch screen guides you through even the most complex operations. Simply make a few touches on the touch screen, your document can be digitized and distribute within seconds.

Preview your copy result on screen

Lets you verify your result and choose which side you want to copy.

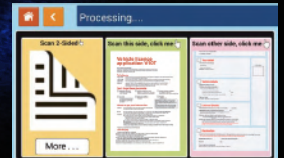

Fast, high-quality printing and copying

Produce professional black and white output at impressive print and copy speeds of up to 50 copies per minute (A4, LEFT).

Advanced scanning capabilities

The product lets you scan paper-based documents in full color in PDF, JPEG, or TIFF file format and send them to a variety of destinations such as E-mail, FTP, USB and network folder (SMB).

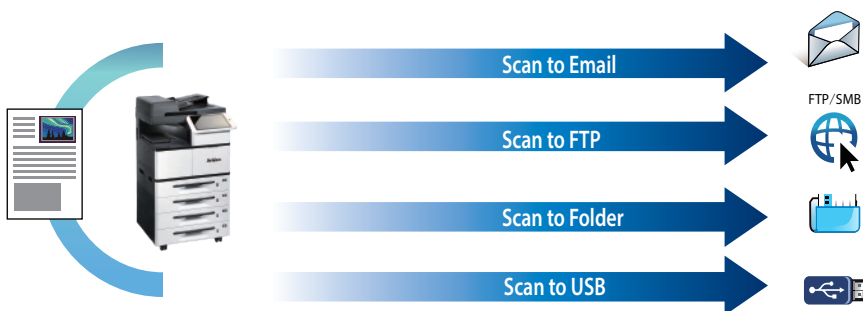

Convenient mobile printing, and scanning



Wirelessly print, or scan from your mobile devices through Avision's app for the MFPs.

Convenient walk-up printing and scanning



A USB direct interface is available for printing files from or scanning files to your USB flash memory drive.

Easy Customization Based on a Popular Tablet System

Based on a popular tablet operating system, the Avision MFP provide convenience to customize your workflow so that your work is easy to be done.



Reduce costs , increase productivity , and improve workflows



Automatic two-sided printing

Allows you to print on both sides of the page, cutting your paper use by up to 50%.

High-yield toner cartridge

The AM7600i Plus Series is shipped with easy-to-install, high-yield 20,000-page toner cartridges that deliver a low cost per page.

High-capacity paper tray

With a main capacity of 530 sheets and expandable to 2,220 sheets, Say goodbye to frequent paper refills, ensuring seamless workflow and increased efficiency.

Get a perfect ID card copy from the AM7600i Plus Series

No need to align your card. The AI image processing technology automatically detects, rotates, crops, and straighten your images. Plus, a few popular layouts have been provided for various requirements.

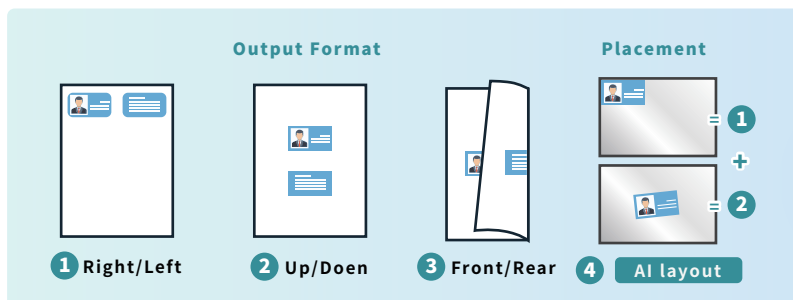

Optimal Security

Control access to MFPs by ID card

The AM7600i Plus Series provides a secure way to access the machine by ID cards. By scanning the ID card on the control panel, administrators can assign usage privileges quickly and easily. The solution is designed for companies with many different departments, all with individual needs and offices concerned with reducing waste and tightening security.



AVISION A3 MFP AM7600i PLUS SERIES



Model		AM7630i Plus	AM7635i Plus	AM7640i Plus	AM7645i Plus	AM7650i Plus
General Specifications						
Functions		Copier - Printer - Scanner - Fax (Option)				
CPU		1.2G Hz (Dual core)				
Memory size		2GB				
Display		10" LCD				
Main Tray	Paper capacity	530 sheets (70 g/m2 plain paper)				
	Paper size	A3, A4, B4(JIS), A5, B5(JIS), A6, B6(JIS), Letter, Legal, Ledger				
	Paper weight	60 to 105 g/m2				
Tray2	Paper capacity	530 sheets (70 g/m2 plain paper)				
	Paper size	A3, A4, B4(JIS), A5, B5(JIS), A6, B6(JIS), Letter, Legal, Ledger				
	Paper weight	60 to 105 g/m2				
Tray3/Tray 4	Paper capacity	530 sheets (70 g/m2 plain paper)				
	Paper size	A3, A4, B4(JIS), A5, B5(JIS), A6, B6(JIS), Letter, Legal, Ledger				
	Paper weight	60 to 105 g/m2				
Manual tray	Paper capacity	100 sheets (70 g/m2 plain paper)				
	Paper size	A3, A4, B4(JIS), A5, B5(JIS), A6, B6(JIS), Letter, Legal, Ledger				
	Paper weight	60 to 163 g/m2				
*Standard support paper capacity		1,160 sheets				
*Maximun support paper capacity		2,220 sheets				
Paper output capacity		500 sheets				
Duplex printing unit		Automatic				
Connectivity	Interfaces	USB2.0				
	Network	10/100/1000 Mbps Ethernet				
Power Source		100-120 VAC, 60 Hz or 220-240 VAC, 50/60 Hz				
Dimension (Wx Dx H)		575 x 602 x 799 mm (22.6 x 23.7 x 31.5 in.)				
Weight(Main Unit)		45 kg (99 lb.)				
Acoustic noise		Standby: < 40 dB ; Operating: < 58 dB				
Print Function						
Printing Method		LSU				
Printing Speed		30ppm	35ppm	40ppm	45ppm	50ppm
First print out time (FPOT)		less than 9 seconds				
Resolution		Up to 1,200 x 1,200 dpi				
Printer language		GDI / PCL / PS				
Copy Function						
Copy Size		A3, A4, B4(JIS), A5, B5(JIS), A6, B6(JIS), Letter, Legal, Ledger				
Max. scanning size		A3 (Ledger at ADF)				
Copy Speed		30cpm	35cpm	40cpm	45cpm	50cpm
Intelligent copy		auto crop / autodeskew / auto blank page removal				
Features		Collate Rotate Collate, Watermark, Toner Save mode				
Scan Function						
Technology		Contact Image Sensor (CIS)				
Optical resolution		Up to 600 x 600 dpi				
Scan speed(ADF)(A4@300 dpi)		80ppm/160ipm				
File format		JPEG, PDF, TIFF				
Features		Network Scan, Scan to USB Disk / FTP / SMB / E-mail / Webpage				
ADF Capacity		100 sheets				
Fax Function (optional)						
Transmission rate		Up to 14.4kbps				
Fax in Queue		Up to 1GB				
Resolution		Up to 200 x 200 dpi				
Fax Features		Memory Fax				
Software/ Consumables						
Software Driver Support		Microsoft Windows Win11/Win10/Win8.X/Win7				
Consumables						
Toner Cartridge		6,000 / 10,000 / 20,000 sheets(A4, 5% cover rate)				
Drum unit		150,000 sheets				
Develop unit		300,000 sheets				
Fusing Unit		300,000 sheets				
Recommended monthly vol		10,000 ~ 30,000 sheets	10,000 ~ 35,000 sheets	10,000 ~ 40,000 sheets	10,000 ~ 45,000 sheets	10,000 ~ 50,000 sheets
Max monthly vol		240,000 sheets	280,000 sheets	320,000 sheets	360,000 sheets	400,000 sheets

* Specifications subject to change without notice. All brand names, product names, and trademarks mentioned in this document belong to their respective holders.